

Design and production of fine quality laser cut models

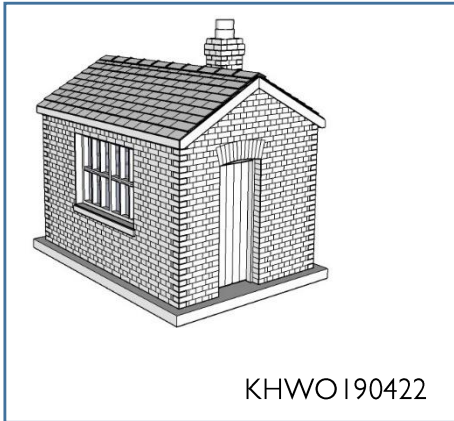

Kings Heath  
weighbridge office

[mk-models.co.uk](http://mk-models.co.uk)

## Instructions

Lay out the parts supplied to familiarise yourself with them.

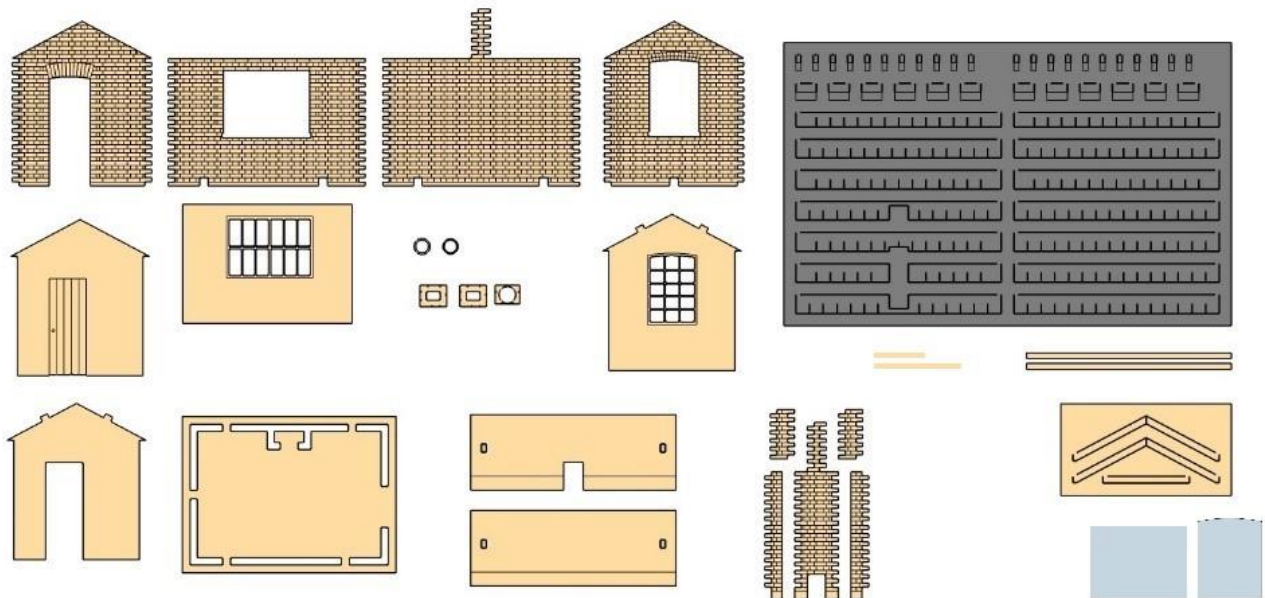

To assemble this kit you will require a good quality PVA adhesive and a craft knife or scalpel for cutting tabs on some parts. You may also find the aid of a pair of tweezers useful.

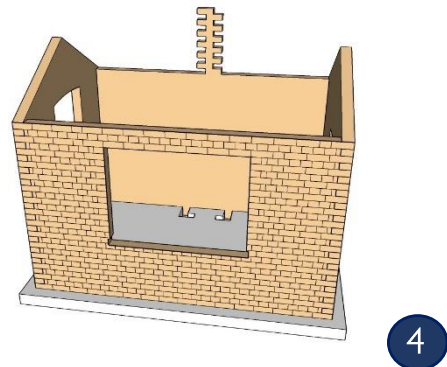
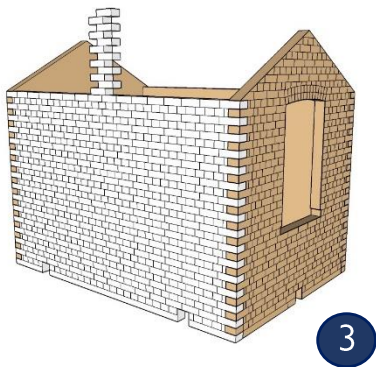
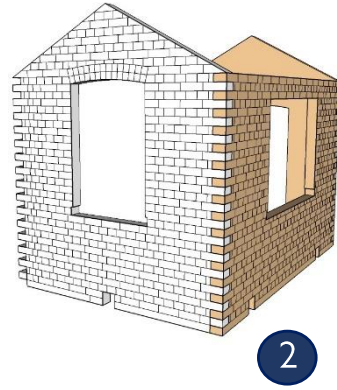
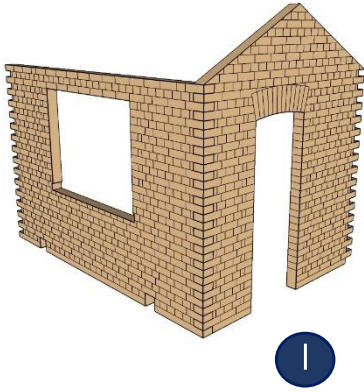

5 Affix glazing parts to the rear of the window frames taking care to note that the left window has detail on the front side.

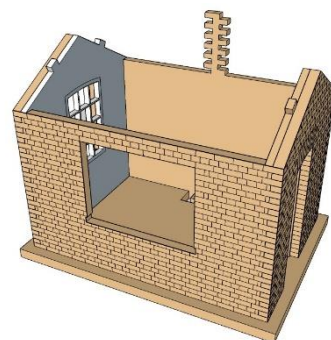
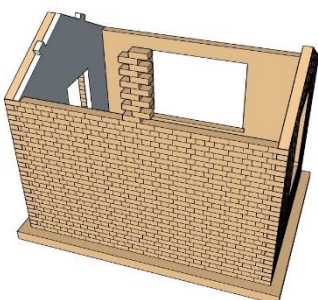
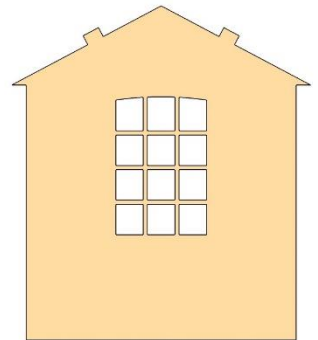
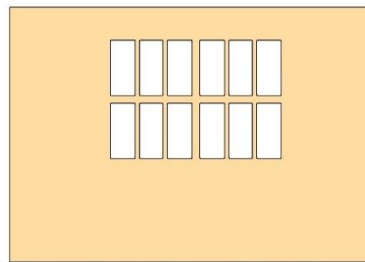

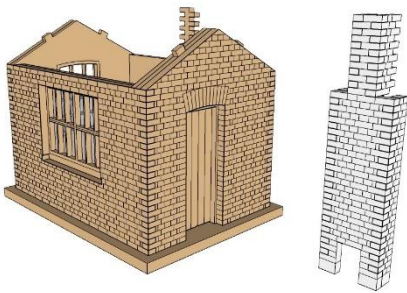
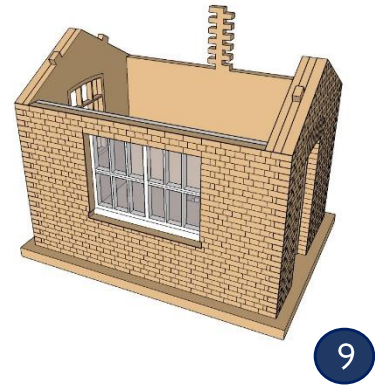
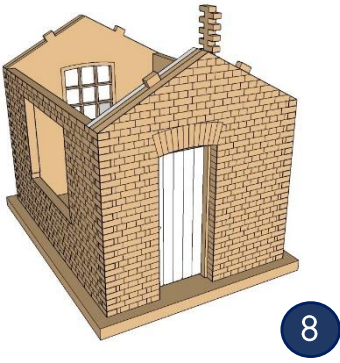

10 Assemble chimney breast parts insuring joints are square.

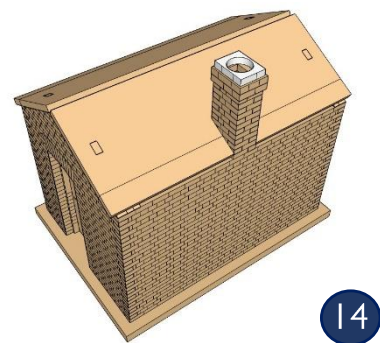
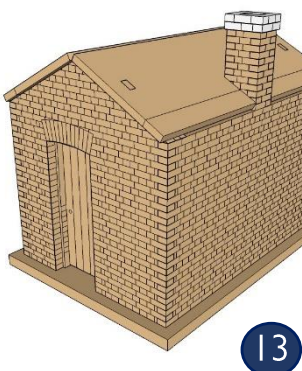
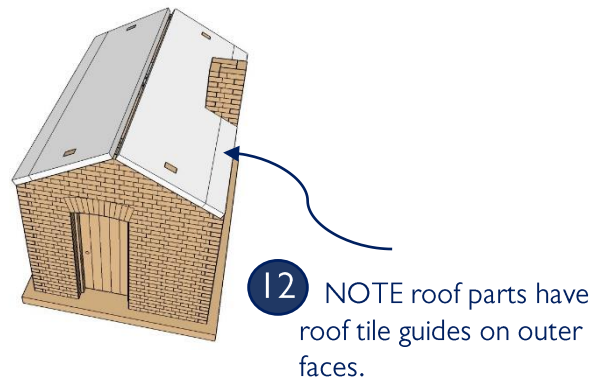
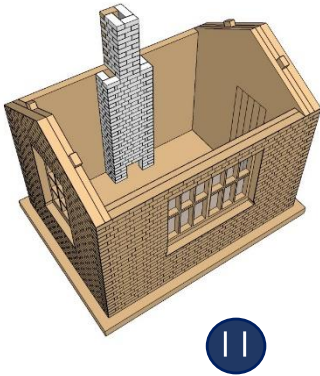

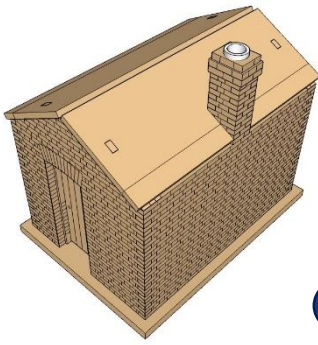

**15** The chimney pot comprises two parts, the smaller of the two should be fixed here.

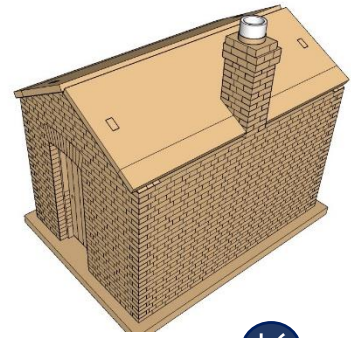

**16**

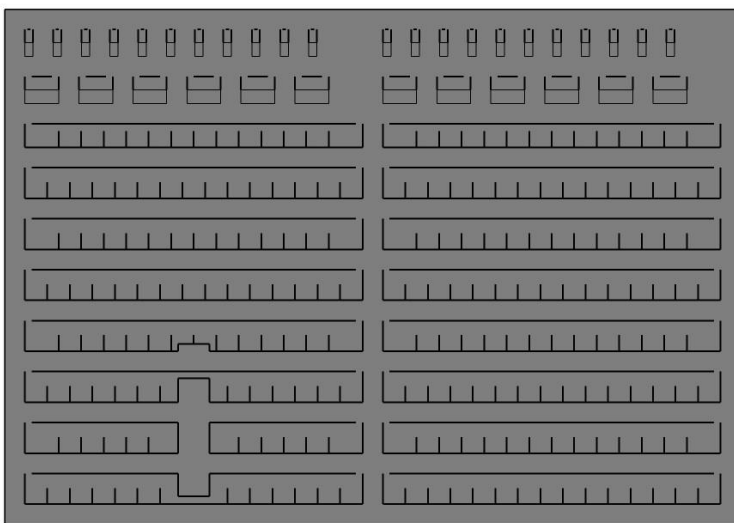

**NOTE** Tiles require releasing from the sheet by cutting through small tabs at left and right top corners of each piece. Tiles for each side of the roof are set out in order starting at the bottom with spare ridge tiles at the top.

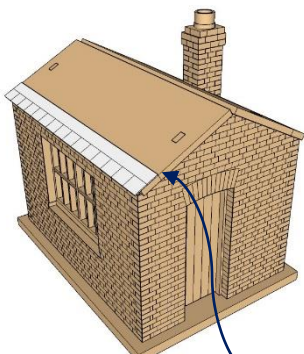

**17** Affix the first row of tiles noting that the top edge should be on the line marked on the roof. Subsequent rows are placed as shown.





18

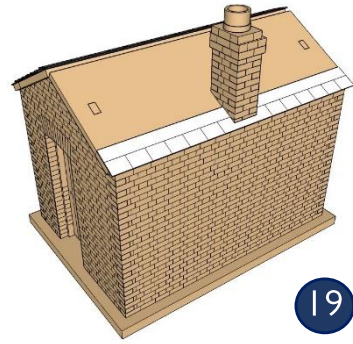

19

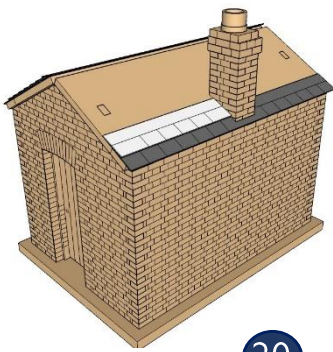

20

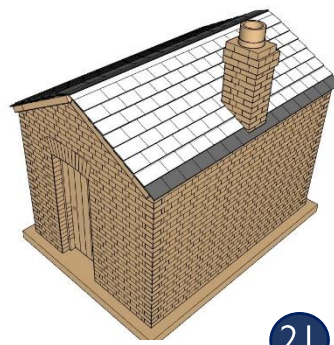

21

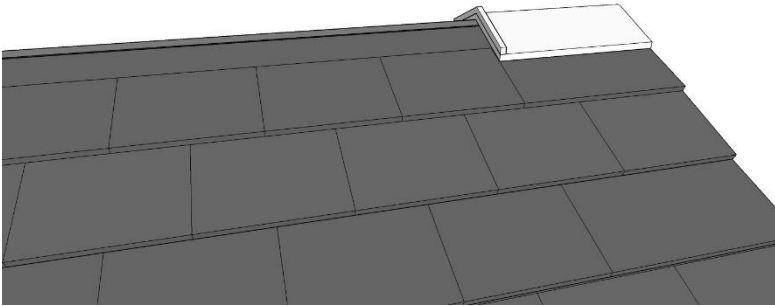

22

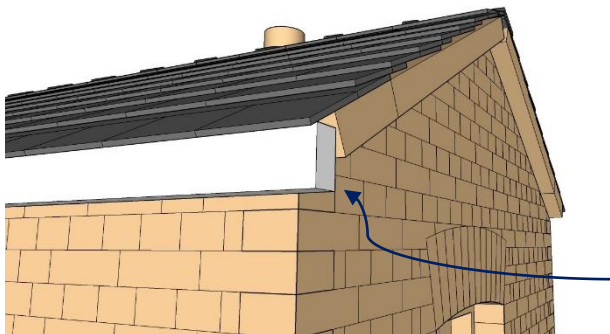

23

Affix fascia boarding to both sides as shown here.

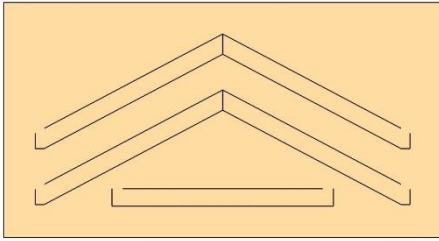

**NOTE** Release parts by cutting through small tabs at top right corners and ends respectively.

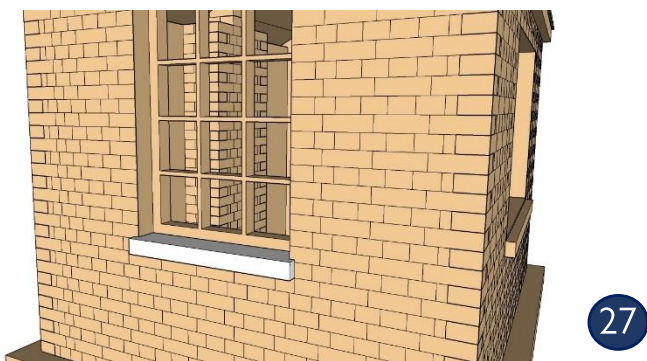
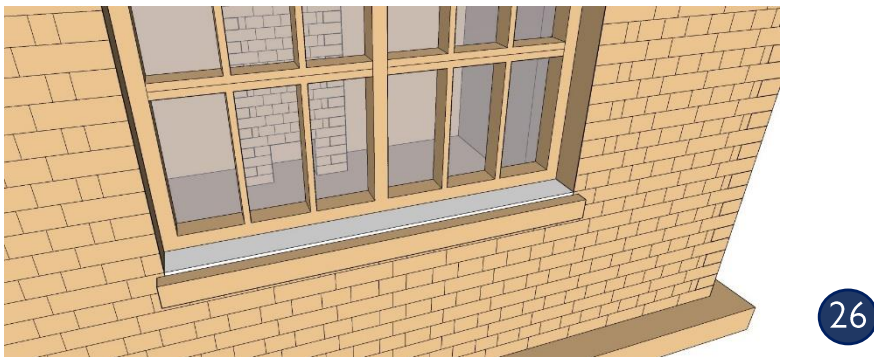



*Enjoy your model !*